

Country of Origin : China  
 Operating Temperature : 0 ~ 40 [°C]  
 Dimension : 93.5 x 46 x 35.8 [mm]  
 Certified AC Plugs : EU, UK, USA/Japan, Aus, Korea  
 Approvals / Marks :



**GREEN MODE**



Efficiency level (ErP) :

**Features:**

- Wall-mount Adapter with Exchangeable AC Plugs. For I.T.E. use only + RoHS conform.
- Wide range Input (90 ~ 264) VAC / (47 ~ 63) Hz.
- Customer can choose one or more from 5 certified plugs Wxx\*(W2E, W2, W3U, W2A, W2K).
- Output connector: standard: 2.1 x 5.5 x 11mm or customer requirement.

**Specification:**

		OUTPUT						
	Model	Voltage DC [V]	Loading [A]	Line/Road regulation [%]	Efficiency [%]	Max. Power [W]	Ripple / Noise [mV] p-p	Connector UL approved [mm]
ErP V.	SYS 1357-1505-Wxx*	5	0~3.00	5	>76.00	15	120	2.1x5.5x11
	SYS 1357-1809-Wxx*	9	0~2.00	5	>80.29	18	120	2.1x5.5x11
	SYS 1357-2412-Wxx*	12	0~2.00	5	>82.00	24	120	2.1x5.5x11
	SYS 1357-2415-Wxx*	15	0~1.60	5	>78.60	24	150	2.1x5.5x11
	SYS 1357-2418-Wxx*	18	0~1.33	5	>78.60	24	180	2.1x5.5x11
	SYS 1357-2424-Wxx*	24	0~1.00	5	>82.00	24	240	2.1x5.5x11
*Wxx	Possible to order with	Wxx =W2E--Europe   W2--USA,Canada,China,Japan   W3U--UK   W2A--Australia   W2K--Korea						
OEM production :	This model is certified for Uout[V] / Pout[W] = (5, 9, 15, 18, 24)V & (5~15W, 5~18, 5~24, 5~24)W by step of 1W							
INPUT	Voltage	(90 ~ 264) VAC						
	Frequency	(47 ~ 63) Hz						
	Current	1A rms@ AC low line input and DC output full load						
	Inrush Current (cold start)	40/60Amax. @ power supply cold start, ambient temperature 25°C@115Vac/230Vac nominal AC input.						
	Leakage current	< 0.25 mA max.						
PROTECTION	Over Current	> 3.3 ~ 5.5A. The power supply will be auto recovered when over current faults remove. (Fold back)						
	Over Voltage	The power supply will not be auto recovered when faults remove 110%-150%. (Voltage limit)						
	Short Circuit	Is defined as any output impedance of less than 0.1Ω. The power supply will be auto recovered when short circuit faults remove.						
OTHERS	Efficiency (typical)	>76.0%@ full load according upon spec						
	Hold up time	10ms min At AC nominal input@ output full load						
	Standby Power	0.3W max.						
	Cooling	Free air convection						
	M.T.B.F.	50K hours full rated load operation at 25°C, according to the MIL-HDBK-217F.						
ENVIRONMENT	Withstand Voltage	I/P-O/P: 3000VAC						
	Temperature	Operating: (0 ~ 40)°C / Storage: (-20 ~ 85)°C						
CONNECTION	Humidity	Operating: 8% ~ 90% RH non condensing / Storage: 5% ~ 95% RH non condensing						
	Input	Plugs: EU, UK, US, AUS, China, Korea --- (exchangeable)						
SAFETY	Output	Plug standard center '+' or customer requirement // Cable length 1,8m or 1,37m(5V/3A)						
	CE,GS, UL, CB, S-Mark, PSE, FCC, CCC, VCCI, BSMI, KC, T-Mark, C-Tick, PSB, SAA/Victoria							
EMC	EMI	EN 55022 Class B (2006) + A1(2007) EN 61000-3-2 (2006) + A1(2009) + A2 Class A(2009)/EN 61000-3-3 (2008)						
	EMS	EN55024(1998)+A1(2001)+A2(2003)   IEC 61000-4-2 (2008)   IEC 61000-4-3 (2006) + A1(2007) + A2(2010) IEC 61000-4-4 (2004) + A1(2010)   IEC 61000-4-5 (2005)   IEC 61000-4-6 (2008)   IEC 61000-4-8 (2009) IEC 61000-4-11 (2004)						
WEIGHT	1pc	N.W.: 155 g/pc + plug						
PACKING	Box	0.53 x 0.41 x 0.46 [m]						
		90pcs / 1box – provide without plugs/plugs are Add separately					G.W.: 22 kg/box	

### Mechanical case specification:

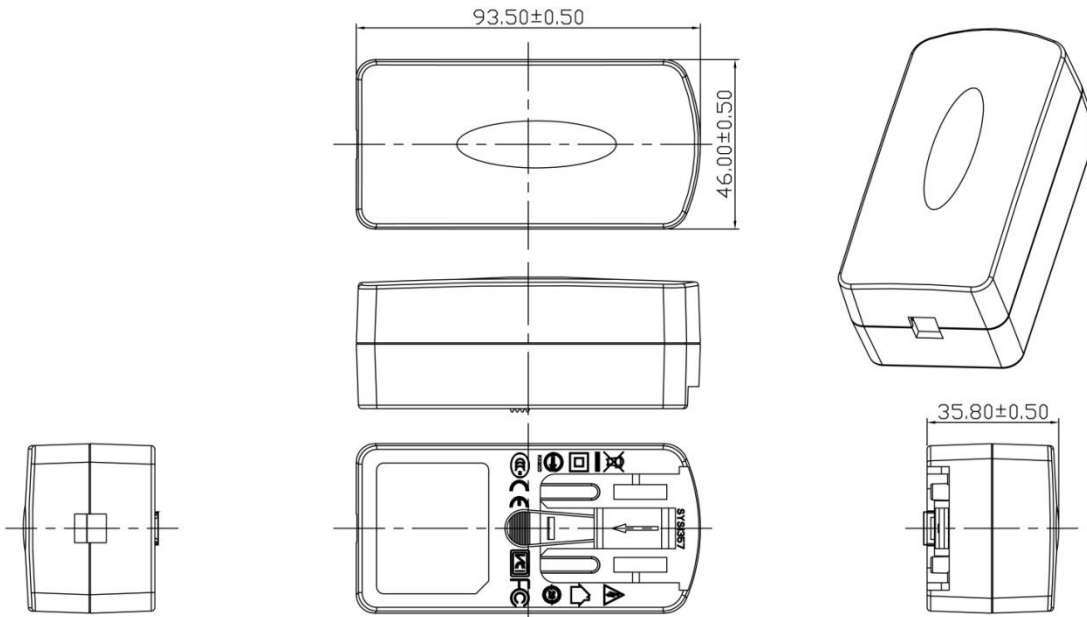

### Mechanical specification (country housing):

#### 1) EU type

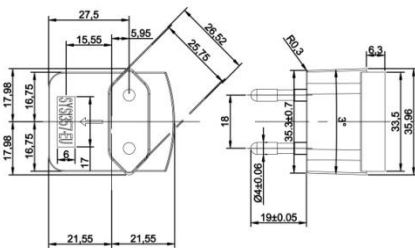

#### 2) USA type

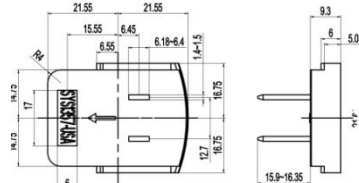

#### 3) AUS type

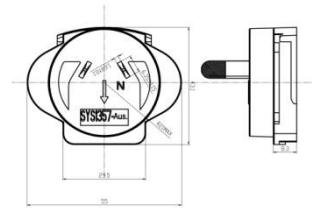

#### 4) UK type

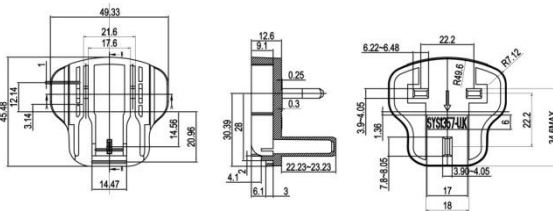

#### 5) Korea type

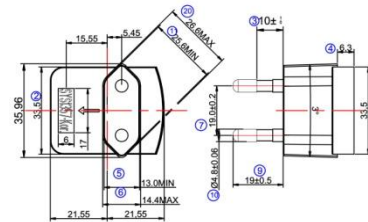

### Cable specification:

#### a) for model SYS1357-1505-Wxx 2468#18\*2C | 1370mm

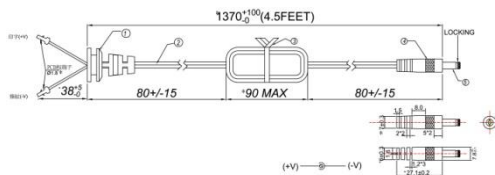

#### b) for all models except SYS1357-1505-Wxx 1185#22\*1C+shield

